

## First floor

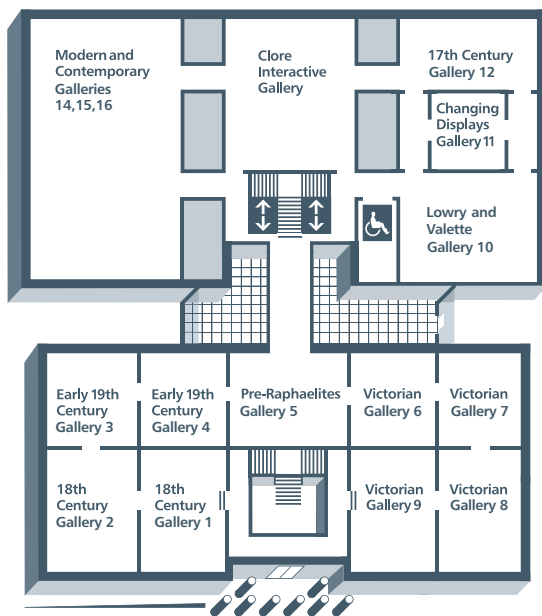

We hope you enjoyed this gallery trail.

To find out more about our collections you can:

Check out our website at [www.manchestergalleries.org](http://www.manchestergalleries.org)

Pick up a free audioguide from our information desk in the atrium.

Buy a copy of *Up Close*, a guide to our collections, on sale in the gallery shop for £4.95.

Or just ask a member of our staff. They'll be happy to help.

## Ground floor



MANCHESTER  
CITY COUNCIL

### Manchester Art Gallery

Mosley Street, Manchester M2 3JL

Tel: 0161 235 8888

Fax: 0161 274 7145

Textphone: 0161 235 8893

[www.manchestergalleries.org](http://www.manchestergalleries.org)

# Discover Manchester Art Gallery Collections Manchester Trail

Three floors. 21 rooms. Over 2,000 items on display spanning over six centuries. No wonder our collection is so renowned.

If you want to find out more about Manchester and its artistic heritage, this short Manchester highlights trail picks out six works in our collection which relate to art and design in the city. You can visit all the works in around half an hour.

**We suggest you start your tour in the ground floor Manchester Gallery, off the entrance hall.**



**Piccadilly Gardens**  
**Lawrence Stephen Lowry**  
**Manchester Gallery. Ground floor.**

This painting is part of the *Changing Views* section of the Manchester Gallery. Piccadilly Gardens is one of Manchester's main public spaces. Lowry's painting shows the gardens revamped after heavy bombing in World War II. The area was radically designed in 2001–2002 and looks very different today.

Copyright Lowry Estate Office.

**The Good Samaritan**  
**George Frederick Watts**  
**Gallery 3. Victorian Galleries. First Floor.**

This painting was presented to the people of Manchester by the artist. Watts made the gift after being inspired by the actions of Thomas Wright, a local foundry worker with a large family to support, who spent much of his spare time visiting prisoners and caring for them on release. The painting was hung in the old Town Hall, and was meant as a moral example to Mancunians.



**Othello, the Moor of Venice**  
**James Northcote**

**Manchester Gallery. Ground floor.**

This striking painting can be found in the *Faces* section of the Manchester Gallery. The picture was the first ever work bought (in 1827) by the Royal Manchester Institution, which became Manchester Art Gallery. The subject is the celebrated black actor Ira Aldridge in his role as Shakespeare's Othello, which he had performed to great acclaim at Manchester's Theatre Royal.



**Albert Square, Manchester**  
**Pierre Adolphe Valette**  
**Gallery 10. Lowry and Valette Gallery. First floor.**

Adolphe Valette was a French artist who created a remarkable series of impressionistic paintings of Edwardian Manchester. This atmospheric picture, painted in 1910, shows the Albert Memorial and other statues in Albert Square, and part of the soot-blackened Town Hall. A horse-drawn cab and the newly-invented motor car indicate the changes to come.



**Manchester Town Hall Goblet**  
**Engraved by William Florian Pohl**  
**Manufactured by Andrew Ker and Company**

**Manchester Gallery. Ground Floor.**

This goblet celebrates the completion of Manchester's magnificent Town Hall in 1877. Manchester's short-lived glass industry was at its height at this time. It attracted foreign workers like Wilhelm Pohl, a skilled glass engraver from Bohemia. These workers brought valuable new skills to local manufacturers.

**Cakebread Street (sunshine after rain)**  
**Liam Spencer**  
**Gallery 10. Lowry and Valette Gallery. First Floor.**

Liam Spencer is one of the Northwest's most popular contemporary artists. He lived and worked in Manchester for many years and this view of Cakebread Street is from a 6th floor studio he once rented in the local area of Ardwick Green. You can see another of Spencer's paintings in the Manchester Gallery on the ground floor.

Purchased with financial assistance from The Friends of Manchester City Galleries.



Copyright of the artist.